

Installation reference drawing

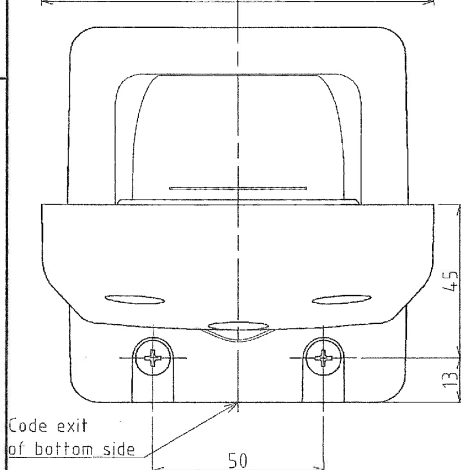

Code exit of bottom side

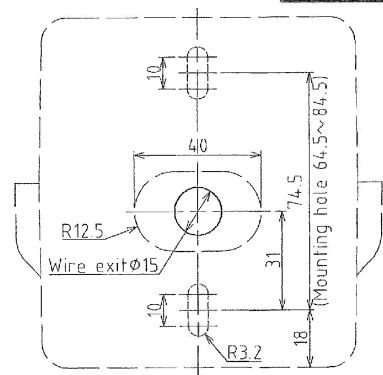

\* Install 2 pcs of M6 screws.  
Mounting surface dimensions

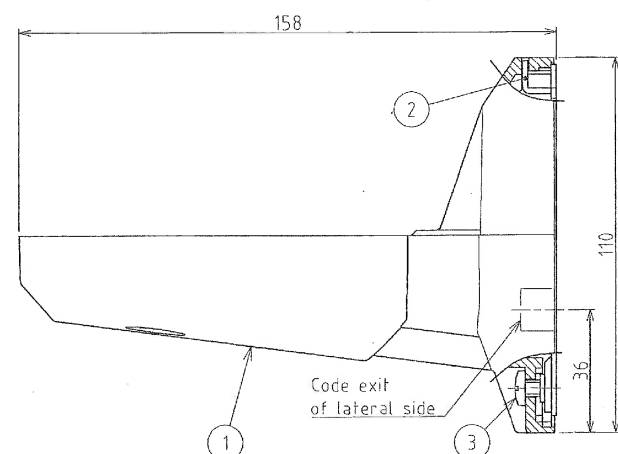

Code exit of lateral side

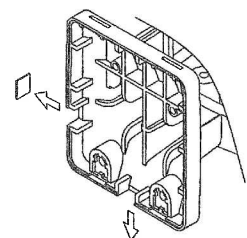

\* Remove the burr after processed  
Processing reference drawing of code exit

# Specifications

Type	RF-001
Available model	Type RFV・RFT
Installation direction	Indoor and Outdoor:Normal direction only
Vibration proof	19.6m/s <sup>2</sup>
Operating temperature range	-15~55°C
Mass	280g±10%

角度公差 ±[°]	寸法公差 ±[mm]	符号 Sym.	年月日 Date	訂正履歴 Revisions	記印 Sgn.	検印 Chk.	承認 App.
10 50 100	6 30 120 300 1000	△					
1 0.5 0.3 0.1	0.05 0.1 0.2 0.4 0.6	△					
3 1.5 1 0.5	0.1 0.2 0.5 0.7 1	△					
粗 c	0.3 0.5 1 1.2 2	△					

## Installation procedure

1. After opened the wire exit of the installation surface, install the chassis by 2 pcs of M6 screws. In case taking out the code from the bottom surface, install lower M6 screw on the upside of the elongate.
2. Install the mount rubber in the product, fix the product to the bracket by the screw after passed the code into the bracket. (Recommended fastening torque:1.4N・m)
3. Pass the code into the wire exit of the mounting surface. And pass the A part of the chassis into the B part of the bracket, and fasten it by the provided M5 screw. (Recommended fastening torque:1.4N・m)

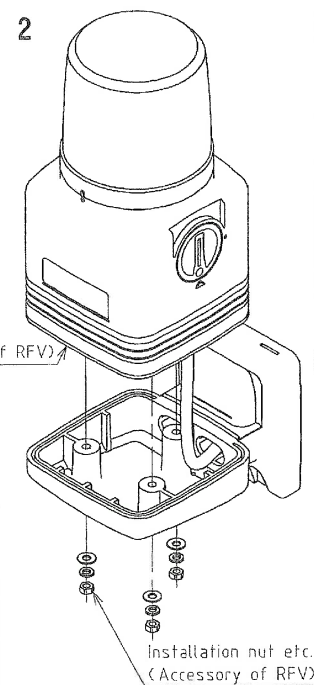
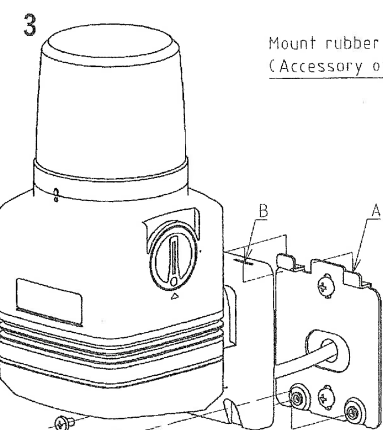
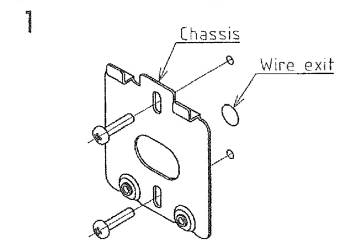

for reference

3	Binding screw M5X8	2	MFZn-C
2	Chassis	1	SPCC
1	Wallmount bracket	1	ABS
番号 No.	部品名 Part Name	品目コード Part No.	数量 Qty.
		材料 & 寸法 & 処理 Material & Size & Finish	記事 Remarks
		機種名 Model	機注No. S.P.No.
		RF-001	
		品目コード Part No.	
三角法 3rd Angle P.	単位 Unit mm	尺度 Scale	株式会社 パトライト PATLITE Corporation
		図番 Drawing No.	RF-001-A18B